

Notes 4/10 - Interior Design

Ex 1: Finding area of rectangles that weren't measured in whole feet

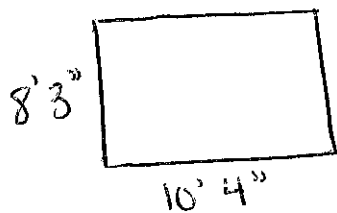

$$\text{On Calc: } \left(8 + \frac{3}{12}\right) * \left(10 + \frac{4}{12}\right) = 85.25 \text{ ft}^2$$

Ex 2: Finding the surface area of walls

• A room is $12' \times 15'$ with $8'$ walls

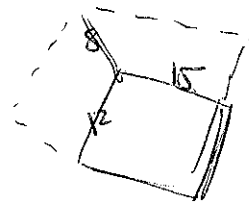
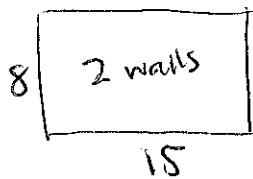
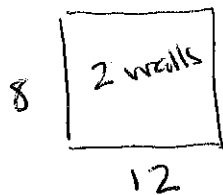

$$SA = 8 \times 12 \times 2 + 8 \times 15 \times 2 = 432 \text{ ft}^2$$

Ex 3: Deciding how much flooring we need.

- To convert ft^2 to yd^2 , just divide ft^2 by 9
- For items sold in cases $\frac{\text{total ft}^2}{\text{ft}^2 \text{ per case}} \Rightarrow \text{round up}$

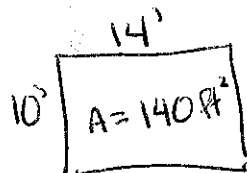

Each case of laminate covers 23.4 ft^2

$$\frac{140 \text{ ft}^2}{23.4} = 5.98 \Rightarrow 6 \text{ cases}$$

Ex 4: Scaling

$$\blacksquare \frac{1}{4} \text{ in} = 1 \text{ ft}$$

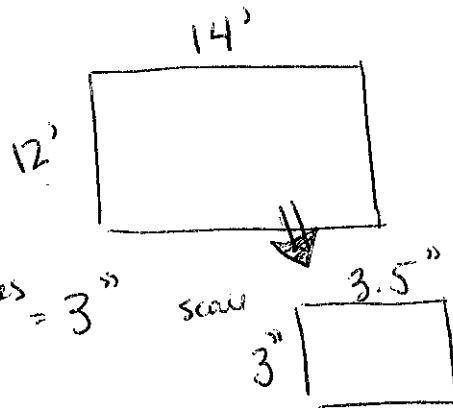

$$12 \text{ ft} \times \frac{\frac{1}{4} \text{ inches}}{1 \text{ ft}} = 3''$$

$$14 \text{ ft} \times \frac{\frac{1}{4} \text{ inch}}{1 \text{ ft}} = 3.5''$$

$$\text{Shortcut} = \times 0.25$$

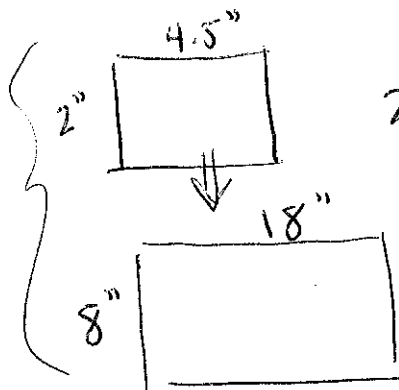

$$2 \text{ inches} \times \frac{1 \text{ ft}}{\frac{1}{4} \text{ inches}} = 8''$$

$$4.5 \text{ in} \times \frac{1 \text{ ft}}{\frac{1}{4} \text{ inches}} = 18''$$

$$\text{Shortcut: } \div 0.25$$